



# INSTALLING DETAIL PARTS ON THE #095 SERIES PS-2 2-BAY HOPPER AND SIMILAR CARS



1) WE'VE INCLUDED SEVERAL OPTIONAL, USER-INSTALLABLE DETAIL PARTS IN SOME OF OUR NEWER FREIGHT CAR MODELS, SUCH AS THE #095-SERIES, THE #107-SERIES, AND THE #123-SERIES. THESE PARTS ARE OPTIONAL, AND MAY BE DIFFICULT TO INSTALL FOR SOME USERS. WE RECOMMEND YOU USE GOOD LIGHTING, MAGNIFICATION, AND RUBBERIZED TWEEZERS.

**TRAINLINE AIR HOSES (X4)**

*\*ONLY TWO PER CAR ARE NEEDED*

**COUPLER CUT LEVERS (X2)**

**NOTE: WE RECOMMEND ONLY ADVANCED MODELLERS ATTEMPT THIS, AS THERE IS A RISK OF DAMAGING YOUR MODEL.**

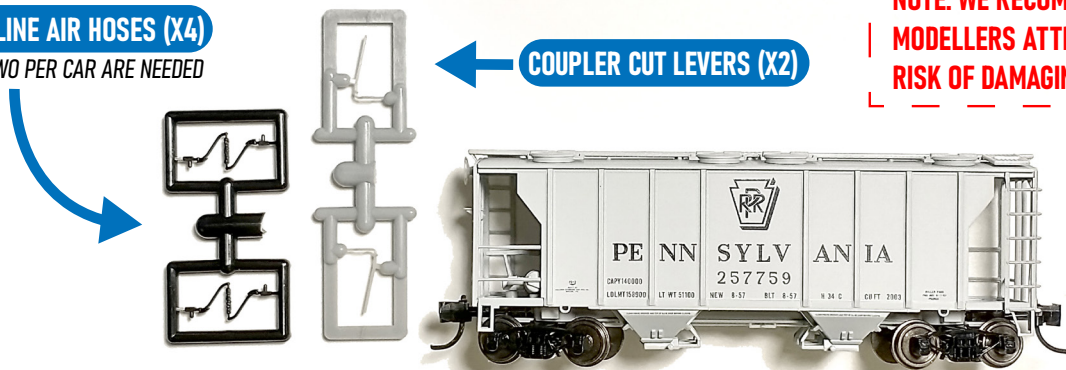

2) FIRST, USING A SHARP HOBBY KNIFE, CAREFULLY TRIM THE PARTS AWAY FROM THE SPRUE, AS SHOWN BELOW. USE CAUTION, AS THE PARTS ARE VERY SMALL AND WILL HAVE A TENDENCY TO SHOOT AWAY WHEN CUT.

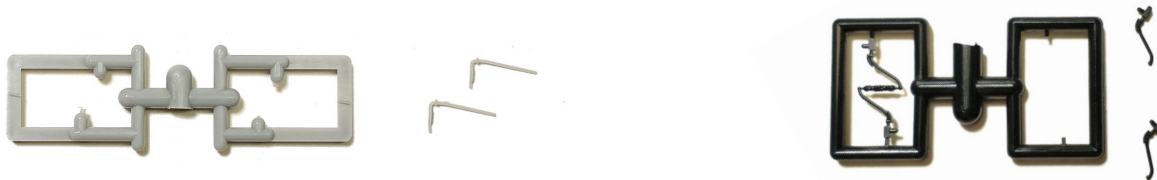

3) USING A PAIR OF SMALL RUBBERIZED PRECISION TWEEZERS, CAREFULLY GRIP AN AIR HOSE AND INSERT THE PIN INTO THE SMALL HOLE IN THE BOTTOM OF THE DRAFT GEAR BOX, AS SHOWN. REPEAT ON OTHER END OF CAR.

**CAUTION: DO NOT APPLY TOO MUCH FORCE WHEN INSTALLING THESE PARTS, AS IT CAN CAUSE DAMAGE TO THE END LADDER CAGE OR COUPLER BOX, OR CAUSE THE COUPLER TO FALL APART.**

**NOTE: THE AIR HOSE IS DESIGNED FOR THOSE WHO DO NOT USE THE MAGNE-MATIC COUPLER SYSTEM, AND REQUIRES THAT YOU TRIM THE TRIP PIN FROM THE COUPLER WITH FLUSH CUTTERS.**

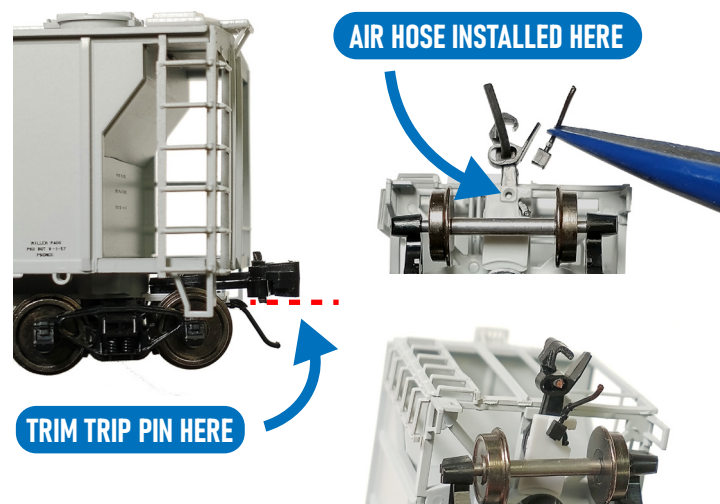

4) USING A PAIR OF SMALL RUBBERIZED PRECISION TWEEZERS, CAREFULLY GRIP A CUT LEVER AND INSERT THE PIN INTO THE SMALL HOLE ON THE END OF THE CAR, AS SHOWN. REPEAT ON OTHER END OF CAR.

THE CUT LEVERS ARE CAST FROM ENGINEERING PLASTIC, SO GLUE AND PAINT DOES NOT ADHERE TO THEM WELL. IF IT IS NOT STAYING IN PLACE, WE RECOMMEND YOU TRY A TACKY GLUE, OR A CYANOACRYLATE ALONG WITH A SURFACE PRIMER LIKE ROKET 'TRICKY STICK'.

**CAUTION: DO NOT APPLY TOO MUCH FORCE WHEN INSTALLING THESE PARTS, AS IT CAN CAUSE DAMAGE TO THE STIRRUP OR THE CAR BODY.**

